



72 BOUL. BRUNSWICK DOLLARD-DES-ORMEAUX, QC

INDUSTRIEL - À LOUER
INDUSTRIAL - FOR LEASE

ESPACE DE 3 200 À 12 146 PI. CA. DISPONNIBLE
SPACE OF 3 200 TO 12 146 SQ. FT. AVAILABLE

- **Facilité d'accès aux Aut. 13 et 40** | *Easy acces to Hwy. 13 and 40*
- **Quais de chargement** | *Loading docks*
- **Hauteur libre de 18'** | *Clear height of 18'*
- **Secteur industriel stratégique** | *Strategic industrial location*
- **À quelques minutes de l'aéroport** | *A few minutes from the airport*



BRASSWATER

245, avenue Victoria,
Suite 801
Westmount, Qc | H3Z 2M6

T: +1 514 535 4444
www.brasswater.ca



TRANSPORT

DÉMOGRAPHIQUE | DEMOGRAPHIC

ACCÈS FACILE À L'AUTOROUTE



ET/AND



EASY HIGHWAY ACCESS

SERVICES ET COMMODITÉS | SERVICES AND AMENITIES

BANQUES | BANKS

BANQUE NATIONALE
RBC
TD CANADA TRUST
BMO
CIBC

RESTAURANTS

3 AMIGOS
MADISONS
AMIR
FIVE GUYS
BOUSTAN
LAFLEUR
SPICEBROS

COMMERCE | SHOPS

L'ÉQUIPEUR
LA BAIE D'HUDSON
WALMART
MARSHALLS
WINNERS
ALIMENTS M&M

OPTION 1

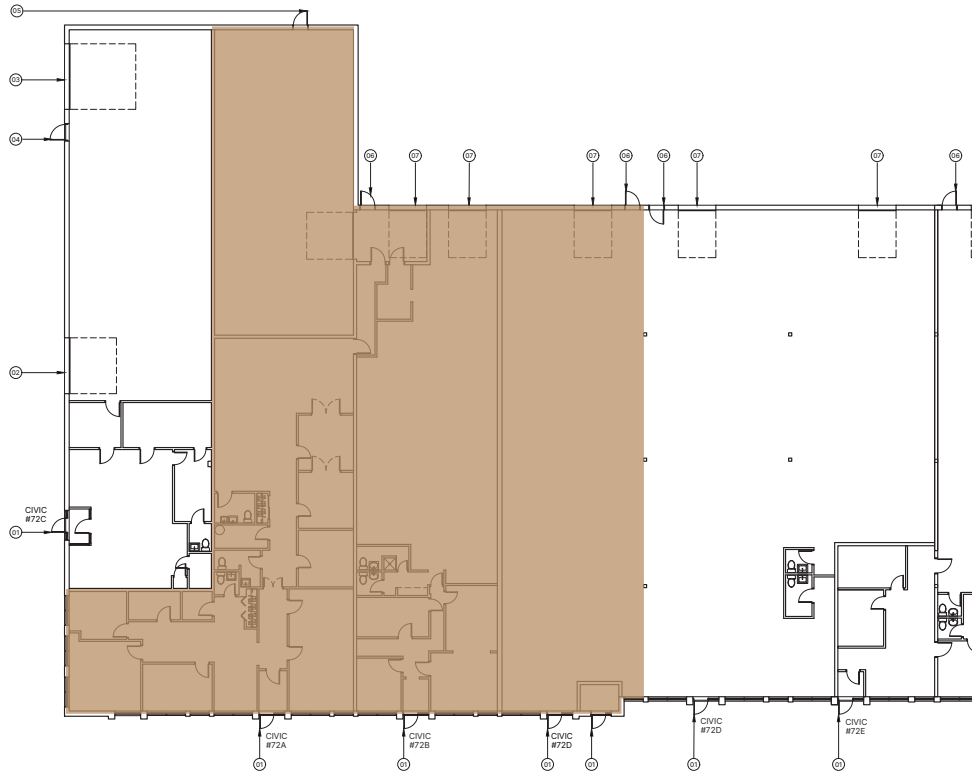

BOULEVARD BRUNSWI

Zonage Zoning	Industriel Industrial
Surfaces disponibles (pi ²) Available Areas (sq. ft.)	12 146
Hauteur libre Ceiling height	18'
Quais de chargements Loading docks	3

OPTION 2

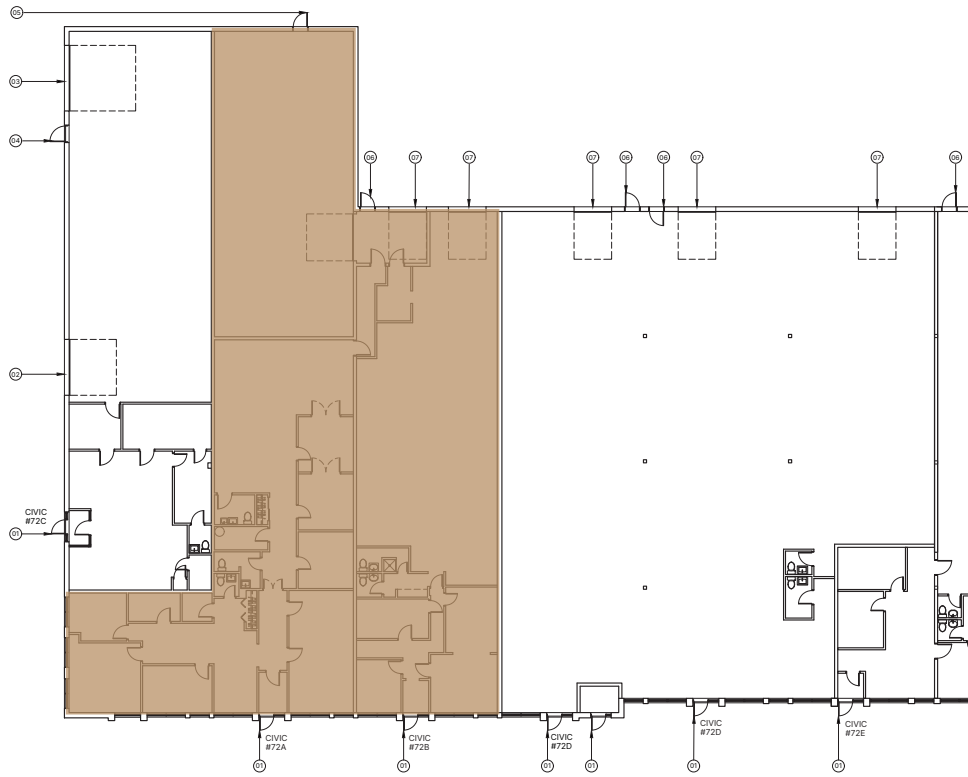

BOULEVARD BRUNSWI

Zonage Zoning	Industriel Industrial
Surfaces disponibles (pi ²) Available Areas (sq. ft.)	8 723
Hauteur libre Ceiling height	18'
Quais de chargements Loading docks	2

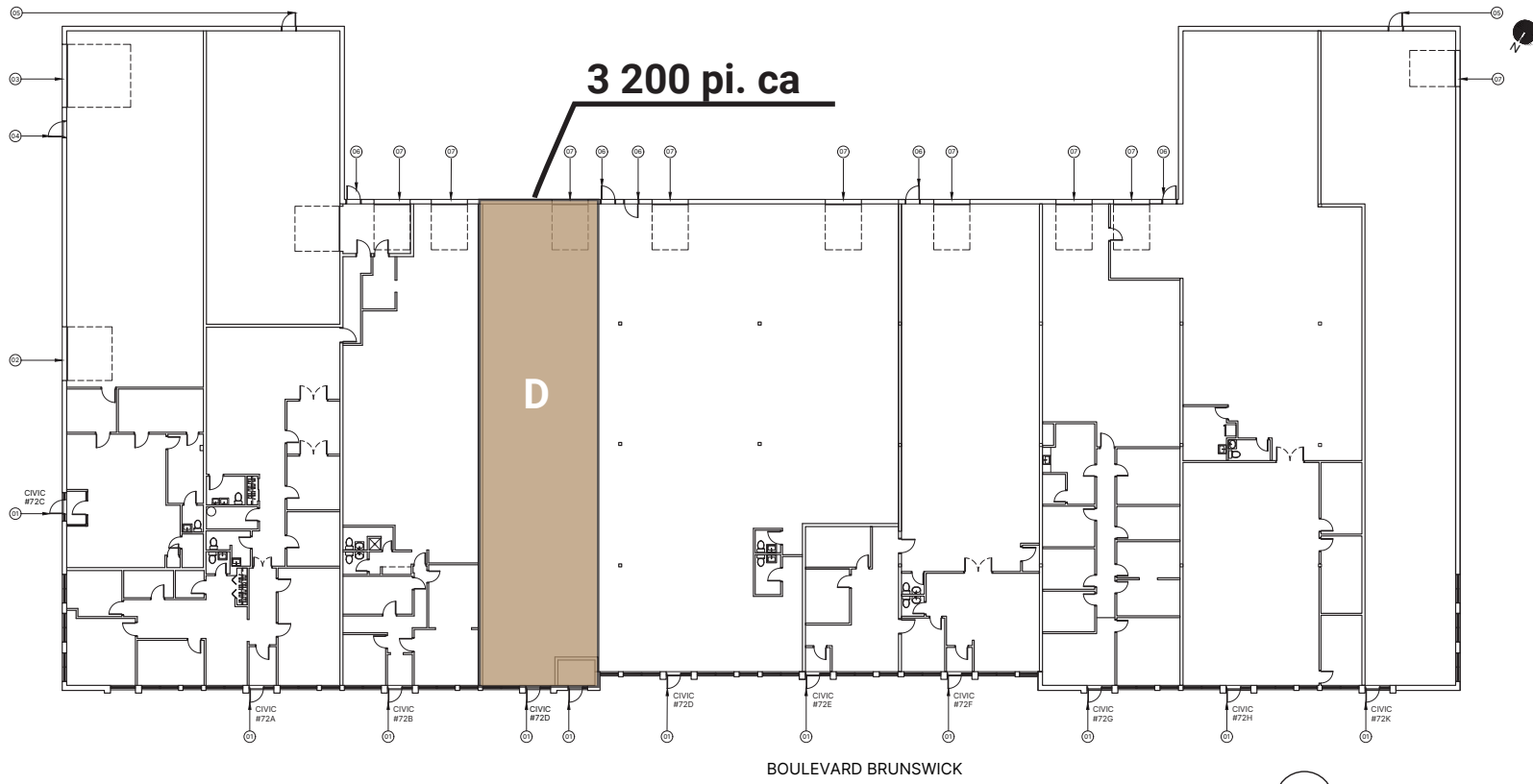

Zonage Zoning	Industriel Industrial
Surfaces disponibles (pi ²) Available Areas (sq. ft.)	3 200
Hauteur libre Ceiling height	18'
Quais de chargements Loading docks	1

BLVD. DES SOURCES



CONTACTEZ-NOUS – CONTACT US

VICTORIA TENENBOYM

Directrice principale à la location
Senior leasing director

T: +1 514 894 6505
vtenenboym@brasswater.ca

ÉQUIPE DE LOCATION LEASING TEAM

T: +1 514 535 4444
leasing@brasswater.ca



BRASSWATER

245, avenue Victoria,
Suite 801
Westmount, Qc | H3Z 2M6

T: +1 514 535 4444
www.brasswater.ca