



QUARTIER DELSON DELSON, QUÉBEC

COMMERCIAL - À LOUER
RETAIL - FOR LEASE

JUSQU'À 8 556 PI. CA. - UP TO 8 556 SQ. FT.

- **Près des autoroutes 15 et 132** | *Close to highways 15 and 132*
- **Adjacent à un nouveau développement résidentiel** | *Adjacent to a new residential development*
- **Entouré de détaillants** | *Surrounded by retailers*
- **Vaste aire de stationnement** | *Large parking area*



BRASSWATER

245, avenue Victoria,
Suite 801
Westmount, Qc | H3Z 2M6
T: +1 514 535 4444
www.brasswater.ca





35,36,40

P
24/7h

TRAFFIC

 32 000
/DAY

POPULATION

 29,188
 63,568

TRANSPORT

DÉMOGRAPHIQUE | DEMOGRAPHIC

ACCÈS FACILE À L'AUTOROUTE



ET/AND



EASY HIGHWAY ACCESS

SERVICES ET COMMODITÉS | SERVICES AND AMENITIES

BANQUES | BANKS

BANQUE NATIONALE
RBC
TD CANADA TRUST
BMO

RESTAURANTS

HARVEY'S
CAVA GRECQUE
TOUJOURS MIKES
BOUSTAN DELSON
LA POKE STATION
DOUBLE PIZZA

COMMERCE | SHOPS

MODE GIOVANNA
HOME DEPOT
WALMART
MAXI
PHARMAPRIX
CANADIAN TIRE
PASQUIER DELSON

HOTELS

HOST HOTEL
L'AUBERGE
ECONO LODGE



Zonage Zoning	Commerce de détail Retail
Surface disponible Available space	JUSQU'À UP TO 8 556 pc/sf
Traffic	32,000 autos par jour
Population	345 135 (10KM) 951 527 (15KM)

Georges-Gagné

Highway 132

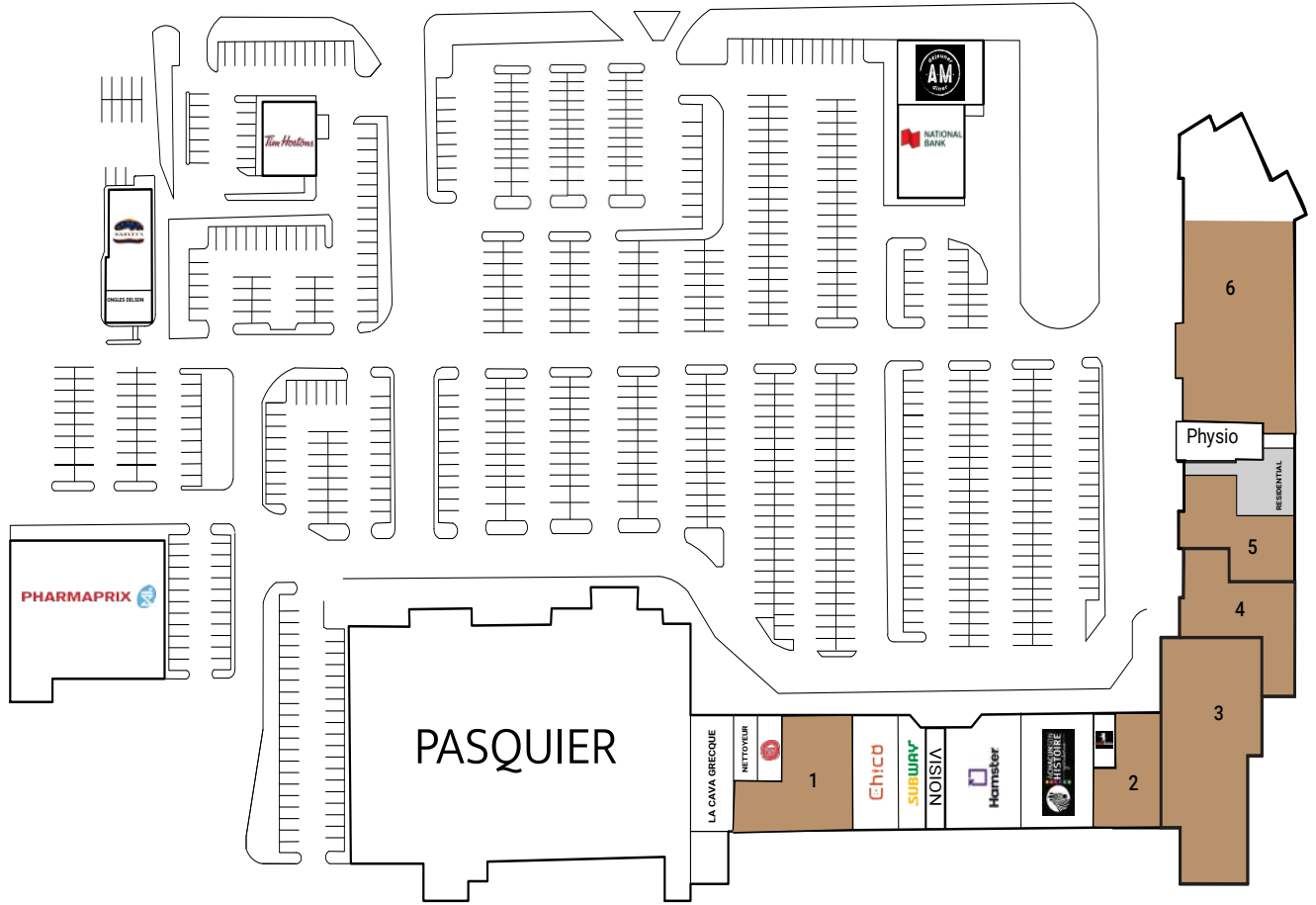

1	35-16A	8 556 pi. ca
2	35-002	4 710 pi. ca

3	#1	6 180 pi. ca
4	#4	1 800 pi. ca

5	#5	1 933 pi. ca
6	#6	6 214 pi. ca



CONTACTEZ-NOUS | CONTACT US

**ÉQUIPE DE LOCATION
LEASING TEAM**

T: +1 514 535 4444
leasing@brasswater.ca

JORDAN KATZ

Directeur principal, location
Senior Leasing Director

T: +1 514 713 5289
jkatz@brasswater.ca



BRASSWATER

245, avenue Victoria,
Suite 801
Westmount, Qc | H3Z 2M6

T: +1 514 535 4444
www.brasswater.ca